

This manual is intended for users of the of the CHMM Mullion Mount with the CCI2D43R. It includes instructions for mounting the CHMM on a metal mullion or wall.



- **This mount is intended to be used with CCI2D43R cameras. Do not use it with other camera models.**
- **This installation should be performed by a qualified service personnel in conformance to all local codes.**
- **Do not use this product for other purposes.**
- **Follow the methods of mounting depending on your installation requirements.**

## Package Contents

Carefully remove the contents from the box, and verify that nothing was damaged in shipping.

- **CHMM Mullion Mount (Partially Assembled)**

- **Accessory Bag**

- 4 x Hole Plugs
- 2 x Steel Washers
- 2 x #02 Phillips Back Box Screws
- 2 x #6 Drywall Anchors
- 2 x #10 Drywall Anchors

- **Template sheet**

## Required Tools

To successfully install the CHMM Mullion Mount the following tools are required:

- **Screwdriver**

- #2 Phillips Head x 2" Minimum

- **Drill Bits**

- #32 (or  $\frac{7}{64}$ " if #32 is not available) for mullion flush installation
- #21 (or  $\frac{5}{32}$ " if #21 is not available) for mullion surface installation
- $\frac{3}{16}$ " for drywall flush installation
- $\frac{1}{4}$ " for drywall surface installation
- A drill bit for a starter hole may be necessary for flush installation depending on cutting tool
- 1" hole bit/saw for surface installations

- **Cutting tools**

- Preferred metal cutting tool such as a die grinder, Dremel<sup>®</sup> oscillating tool, handsaw, hole saw, etc. for flush mullion installation
- Preferred drywall cutting tool such as a drywall saw for drywall installation

## Dimensions

Unit: Inches (Millimeters)

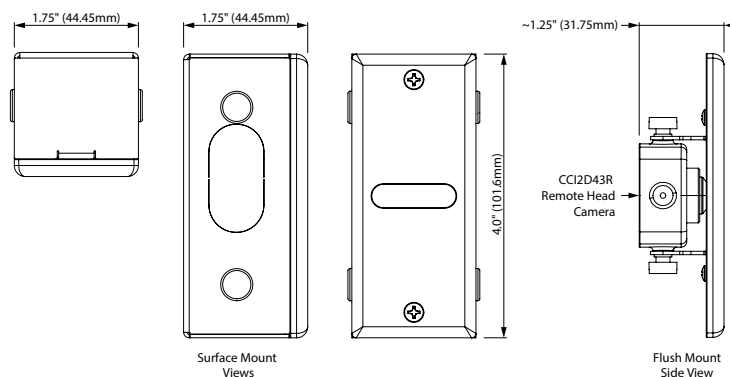

## Initial Assembly

- 1 Remove screws holding wall plate to Back Box.
- 2 Remove wall plate from Back Box

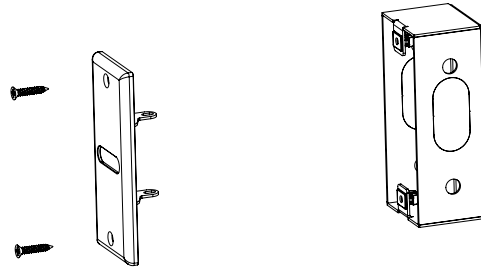

- 3 Prepare the CCI2D43R Remote Camera Module for installation in the wall plate by removing the thumb-screws from the camera bracket and removing the camera module.
- 4 Install the camera module into the brackets using the thumb-screws supplied with the camera module and the nylon washers in the CHMM Accessory Bag. Be sure to check the orientation of the camera module. The text on the module's rear label should be reading correctly and the cable connector should be on the bottom of the module.
- 5 Tighten thumb screws by hand until snug. Do not tighten fully as this will be done during final installation procedure.

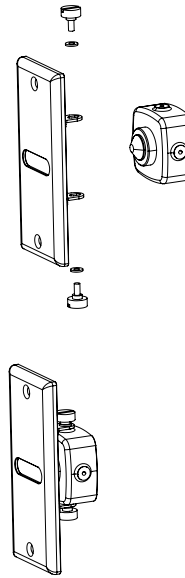

- 6 Determine the mounting method for installation and continue installation. The continued installation instructions can be found at:  
"Flush Mount Installation" on page 3  
"Surface Back Installation" on page 4  
"Surface Side Installation" on page 5

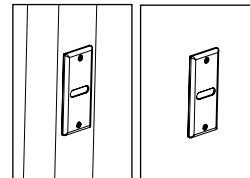

Flush Mount

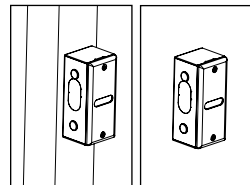

Surface Mount Back

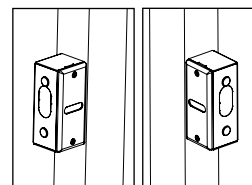

Surface Mount Side

## Flush Mount Installation

- 1 Cutout template **FLUSH MOUNT** along outline from included Camera Mounting Template and set aside the CHMM Back Box as it is unused for flush mounting.
- 2 Determine desired mounting location.
  - It is recommended that the actual field-of-view from the live camera be used to determine the desired mounting location
  - In place of using the camera to determine the proper height, a height of approximately 5 - 5.5 feet above ground level is recommended.
- 3 With the location determined, apply the template to mullion or wall.
- 4 Use the template to create 2 holes for the wall plate. For a mullion installation use a #32 drill bit. If a #32 drill bit is not available, substitute using a  $\frac{7}{64}$ " drill bit. For drywall use a  $\frac{3}{16}$ " drill bit.
- 5 Using the hatched area marked **REMOVE** on the template as a guide, use a cutting tool to make a hole in the mullion or drywall drilling a pilot hole if necessary.
- 6 Connect main unit with the camera module connection cable using a Cat5e cable and pull through the rectangular cutout.
  - It is recommended to install the CCI2D43R main unit, run the necessary cable down the mullion or wall, and test the camera prior to installing the camera module and mount.
  - Consult the CCI2D43R Installation Manual for cable and main unit installation requirements.
- 7 Prior to securing the wall plate screws, the camera module thumb screws can be slightly loosened to allow the camera to pivot left and right to achieve desired view. Once desired view is achieved fully tighten thumb screws.
- 8 For drywall installations, install the included #06 wall anchors. Secure the mount to the mullion or wall with (2) Wall Plate screws. Be careful not to over tighten as this could strip the threads. Only tighten until snug.

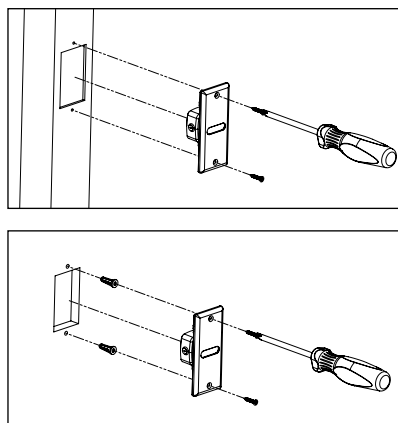
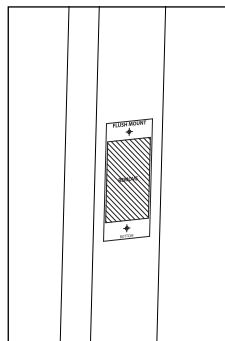

- 9 Once complete with install this is what the mount will look like.

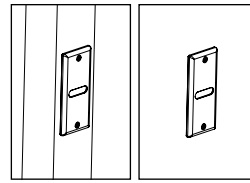

## Surface Back Installation

- 1 Cutout template **SURFACE MOUNT BACK** along outline from included Camera Mounting Template.
- 2 Determine desired mounting location.
  - **It is recommended that the actual field-of-view from the live camera be used to determine the desired mounting location**
  - **In place of using the camera to determine the proper height, a height of approximately 5 - 5.5 feet above ground level is recommended.**
- 3 With the location determined, apply the template to mullion or wall.
- 4 Use the template to create 2 holes for the wall plate. For a mullion installation use a #21 drill bit. If a #21 drill bit is not available, substitute using a  $\frac{5}{32}$ " drill bit. For drywall use a  $\frac{1}{4}$ " drill bit.
- 5 Using the template as a guide, drill a 1" hole in the mullion or drywall.
- 6 Connect main unit with the camera module connection cable using a Cat5e cable and pull through the hole.
  - **It is recommended to install the CCI2D43R main unit, run the necessary cable down the mullion or wall, and test the camera prior to installing the camera module and mount.**
  - **Consult the CCI2D43R Installation Manual for cable and main unit installation requirements.**
- 7 On the Back Box break off the oval knockout tab on face that will be touching the mullion or wall and pass the cable through hole in the Back Box.
- 8 Install one of the included hole plugs in each of the four holes on either side of the Back Box.

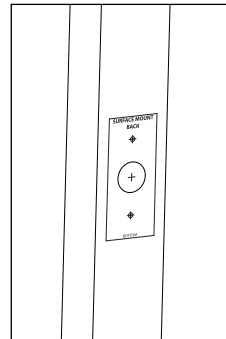

- 9 For drywall installations, install the included #10 wall anchors. Secure the backbox to the mullion or wall with the (2) #02 Back Box screws included. Be careful not to over tighten as this could strip the threads. Only tighten until snug.
- 10 Prior to securing the Wall Plate screws, the camera module thumb screws can be slightly loosened to allow the camera to pivot left and right to achieve desired view. Once desired view is achieved fully tighten thumb screws.
- 11 Secure the Wall Plate to the Back Box with (2) Wall Plate screws. Be careful not to over tighten as this could strip the threads. Only tighten until snug.
- 12 Once complete with install this is what the mount will look like.

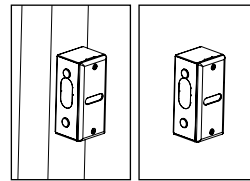
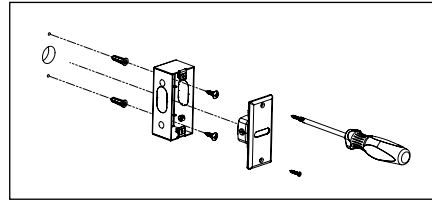
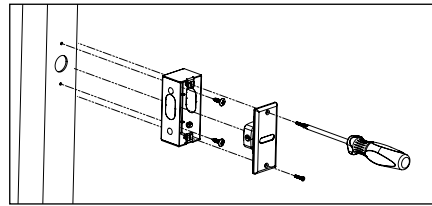

## Surface Side Installation

- 1 Locate template **SURFACE MOUNT RIGHT** or **SURFACE MOUNT LEFT**, depending on the desired mounting orientation, and cut along outline from the included Camera Mounting Template.
- 2 Determine desired mounting location.
  - It is recommended that the actual field-of-view from the live camera be used to determine the desired mounting location
  - In place of using the camera to determine the proper height, a height of approximately 5 - 5.5 feet above ground level is recommended.
- 3 With the location determined, apply the template to mullion or wall.
- 4 Use the template to create 2 holes for the wall plate. For a mullion installation use a #21 drill bit. If a #21 drill bit is not available, substitute using a  $\frac{5}{32}$ " drill bit. For drywall use a  $\frac{1}{4}$ " drill bit.

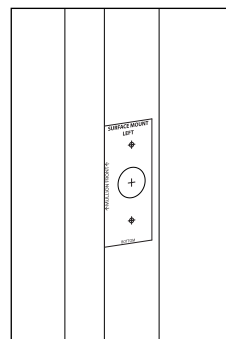
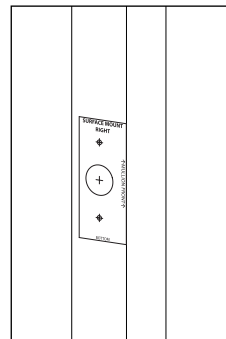

- 5 Using the template as a guide, drill a 1" hole in the mullion or drywall.
- 6 Connect main unit with the camera module connection cable using a Cat5e cable and pull through the hole.



- **It is recommended to install the CCI2D43R main unit, run the necessary cable down the mullion or wall, and test the camera prior to installing the camera module and mount.**
- **Consult the CCI2D43R Installation Manual for cable and main unit installation requirements.**

- 7 On the Back Box break off the oval knockout tab on face that will be touching the mullion or wall and pass the cable through hole in the Back Box.

- 8 For drywall installations, install the included #10 wall anchors. Secure the backbox to the mullion or wall with the (2) #02 Back Box screws included by passing the screwdriver through the holes on the side opposite mullion or wall. Be careful not to over tighten as this could strip the threads. Only tighten until snug.

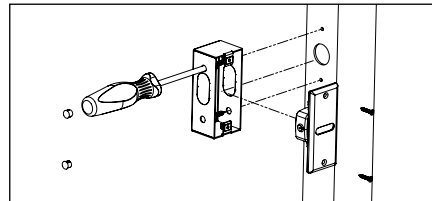

- 9 Prior to securing the Wall Plate screws, the camera module thumb screws can be slightly loosened to allow the camera to pivot left and right to achieve desired view. Once desired view is achieved fully tighten thumb screws.

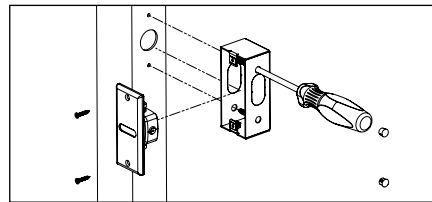

- 10 Secure the Wall Plate to the Back Box with (2) Wall Plate screws. Be careful not to over tighten as this could strip the threads. Only tighten until snug.

- 11 Install one of the included hole plugs in each of the four open holes of the Back Box.

- 12 Once complete with install this is what the mount will look like.

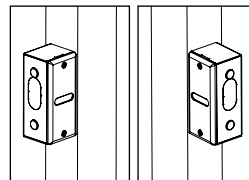

**COSTAR**  
**COSTAR VIDEO SYSTEMS**

101 Wrangler Drive, Suite 201 Coppell, Texas 75019

Phone: (469) 635-6800 Fax: (469) 635-6822

Toll-free: (888) 694-7827

# CHMM INSTALLATION TEMPLATES

