



StarNET Mobile

User's Manual

Before reading this manual

StarNET Mobile for Android is an app for connecting to a device (DVR, NVR, network video transmitter or network camera) using mobile device running on Android platform and remotely monitoring videos via a network connection.

NOTE: Connecting to certain devices may not be supported depending on device's specifications and version.

System Requirements

OS	Google Android 3.0~ (Icecream sandwich~)
Processor	ARMv7-A compatible
Display	320x480 pixels to 1080x1920 pixels (320dp to 1080dp)
Storage	25MB or more
Network	Wi-Fi or mobile network (3G or 4G) provided by the Android mobile device

App Installation

1. Open the Play Store (Google Play) on your Android device.
2. In Play Store (Google Play), enter StarNET Mobile in the search field.
3. Install StarNET Mobile and open it.

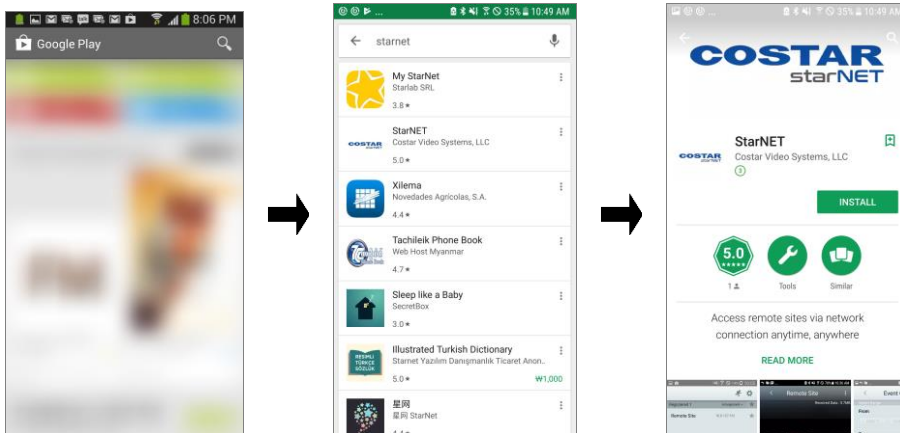

NOTE: To uninstall StarNET Mobile, go to *Settings* → *Applications* → *Manage applications*. Select *StarNET Mobile* and press *Uninstall*.

CAUTION: This service requires heavy data traffic, and using a Wi-Fi connection is recommended. Using wireless internet (3G, LTE) may result in excessive data charges.

Running & Configuring App

Launch StarNET Mobile. The following start-up screen will appear.



[Title Bar]

-  (Settings): Change settings of StarNET Mobile or view information.

[Device List Options]

- Registered: Shows the number of registered devices.
- Arrangement: Sort the list in ascending or descending order.
-  (Favorites): Shows devices registered as favorites on top.

Setup

Press  (Settings) on the title bar at the top to check the settings of StarNET Mobile and make changes if necessary.

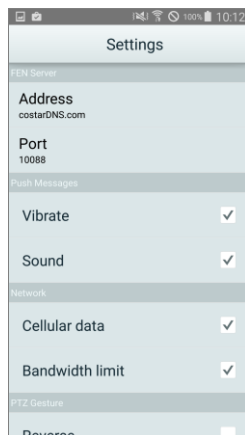
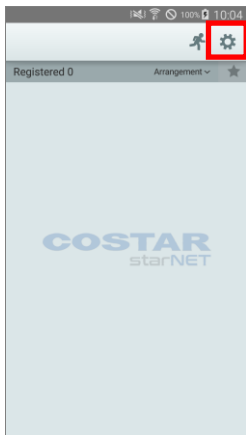

- FEN Server: If the device is using an additional FEN server, enter the FEN server information. (Default site: costarDNS.com, Default port number: 10088).
NOTE: For more details, contact your FEN server administrator.
- Cellular data: Enable/disable cellular data use.
- Bandwidth limit: Receives small data if an additional stream is available on the remote site.
- PTZ Gesture: If you select **Reverse**, the PTZ camera will pan in the opposite direction when you drag the screen in PTZ mode.

- Passcode Lock: Secures the application with a user passcode.
- Backup: Saves StarNET Mobile's settings as a file. The setting file will be sent via email, and email account should be set up in prior for this option to work.

Device Registration

1. Press the Menu button on your mobile device. The following start-up screen will appear.



- New site: Registers device.
- Delete site: Deletes device. Only displayed when a registered device exists.

2. Register the device by pressing New Site and entering the device information.

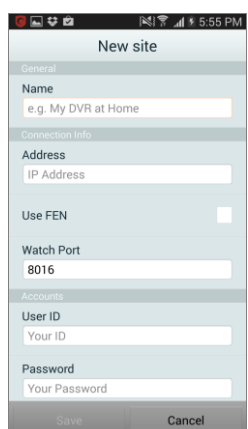

- General: Enter a name of the device to be used in StarNET Mobile.
- Connection Info: Configure FEN, remote address, and remote port settings.

NOTE: Deselect the checkbox if FEN is not enabled on the device. If using a separate FEN server, tap (Settings) to configure FEN server settings (Default site: dvnames.net, Default port number: 10088). For more details, contact your FEN server administrator.

NOTE: If FEN feature is not enabled on the device, deselect *Use FEN* checkbox and enter the device's IP address under Address. Default value is recommended for the Port setting.

- Accounts: Enter the User ID and Password used to login to the device.

3. To modify information about registered devices, select the device from the device list. When the menu appears, select Edit and modify the device information.

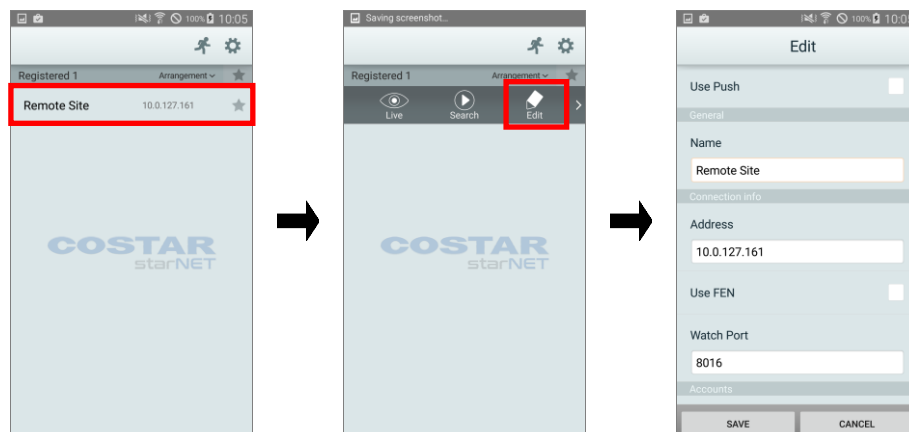

Push Message

It is possible to receive device-event alerts on the mobile device as push messages. To enable push messages, configure StarNET Mobile I as described below.

NOTE: This feature is available only with devices that support push messaging and needs to be set up beforehand in order to function correctly. For more information, refer to the concerned device's operation manual.

1. Select a device on the device list. From the menu that appears, select **Edit** and then set the **Use Push** option to **On**.
2. When a device event occurs, **Push Message** button will be shown on the title bar at the top, along with . Tap on the button to read the push message.

Live

Select a device on the device list. When the menu appears on the screen, select **Live**. The live video from the selected device will be displayed on the screen.

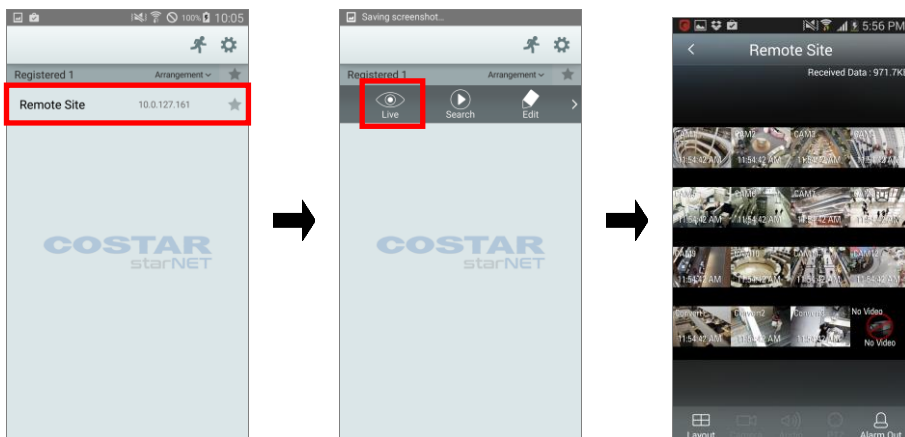

- **Screen:** Tap the screen to view video from the current camera in 1x1 layout. See below for information on screen controls.

Return to the previous screen	Tap the mobile device's Cancel button
Go to previous or next camera group (if a video exists in the next camera group)	Drag the screen to left and right
Hide/show the camera's OSD (1x1 layout only)	Tap on camera screen
Original Screen/Full Screen	Repeatedly tap on camera screen
Disconnect and return to startup menu	Tap (Back) on the title bar at the top
Digital Zoom (1x1 layout only)	Press two points on the screen and drag to zoom in/out

- **Received Data:** Displays current connection's network usage.

NOTE: Not support in portrait mode.

- : Change screen layout. Press the button to view the list of available layouts. Select the desired layout from the list. In landscape mode, press and hold on the screen to bring up the layout list.

- : Show list of camera channels. Press the desired channel to view videos from the selected camera.

NOTE: Not support in portrait mode.

- : Supports two-way audio communication with the device.

NOTE: Only supported in 1x1 layout.

NOTE: Layout or camera channel cannot be changed while in Two-way Audio mode. Changing the camera channel automatically disables two-way audio mode.

- : In PTZ Mode, you can control PTZ cameras.

NOTE: Only supported in 1x1 layout.

NOTE: This function is not supported if a PTZ camera was not configured on the device. The PTZ icon is displayed on the camera screen if PTZ mode is supported.

- : Enable/disable alarm outs and beeps on devices that support alarm out.

NOTE: Some functions may not be supported depending on the device specifications or version. If a function is not supported, buttons for unsupported functions are either not shown or deactivated.

From Live screen, press the Menu button on your mobile device. This makes it possible to use Search and Capture features.

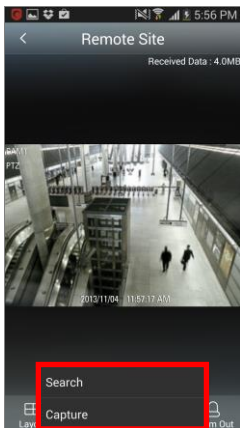





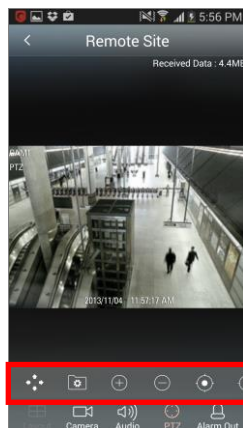
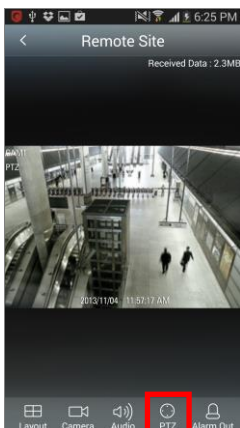

- Search: Switches over to the device's search screen.
- Capture: Captures the current frame. Captured frames are saved under /DCIM/Screenshots/StarNET/.

NOTE: Capture is supported in 1x1 layout only.

PTZ Control

Tap . In PTZ Mode, you can control PTZ cameras.



-  (Pan): Displays 8 direction buttons. Touch the screen to move the camera screen when the Pan button is not selected.
-  (View Presets): Show list of device's presets. Press the preset to pan the PTZ camera to the preset position.
-  (Zoom In/Out): Zoom in or out on the video. Place two fingers on the screen and move them closer or farther apart to zoom in/out.
-  (Near/Far Focus): Change the camera's focus between near and far.
-  (Close/Open Aperture): Close or open aperture.



NOTE: Certain PTZ functions may not be supported in landscape mode.

Fisheye Camera Control

Watch

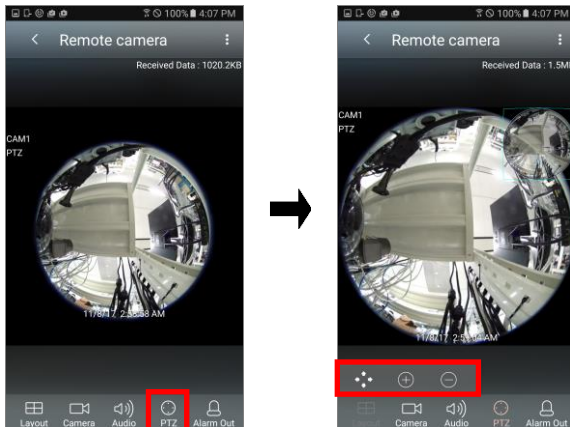
Tap . In PTZ Mode, you can control Fisheye cameras. The original fisheye video is displayed at the right top of the screen and the rectangle indicates the currently monitored area.





-  (Pan): Displays 8 direction buttons. Touch the screen to move the fisheye camera screen when the Pan button is not selected.
-   (Zoom In/Out): Zoom in or out on the video. Place two fingers on the screen and move them closer or farther apart to zoom in/out.

Search

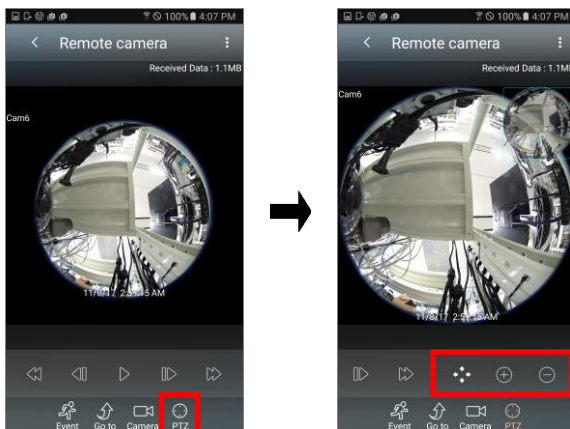
Tap . In PTZ Mode, you can control the recorded fisheye videos. The original fisheye video is displayed at the right top of the screen and the rectangle indicates the currently monitored area. Pan and Zoom In/Out buttons which are activated by PTZ button, appear on the right side of the Fast-forward button. The area of the button can be scrolled in the left/right directions.



-  (Pan): Displays 8 direction buttons. Touch the screen to move the fisheye camera screen when the Pan button is not selected.
-   (Zoom In/Out): Zoom in or out on the video. Place two fingers on the screen and move them closer or farther apart to zoom in/out.

Search & Playback

Select a device on the device list. When the menu appears on the screen, select **Search**. The video recording from the selected device will be displayed on the screen.

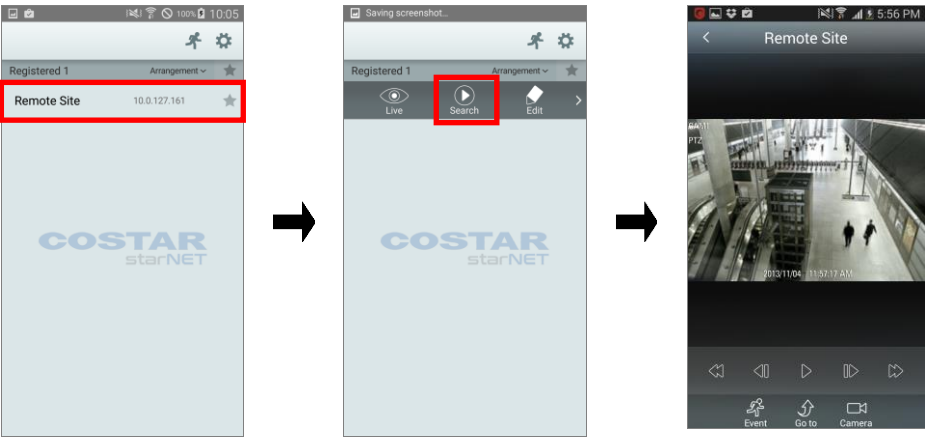

- **Screen:** Tap the screen to view video from the current camera in 1x1 layout. See below for information on screen controls.

NOTE: Only supported in 1x1 layout.

Return to the previous screen	Tap the mobile device's Cancel button
Show/hide OSD on the subject camera	Tap on camera screen
Disconnect and return to startup menu	Tap (Back) on the title bar at the top
Digital Zoom	Press two points on the screen and drag to zoom in/out

- **Received Data:** Displays current connection's network usage.

NOTE: Not support in portrait mode.

- (Play/Pause): Stop or play video recording shown in the current screen.
- (Go to Previous/Next Video): Go to previous or next video by frame or time.
- (High-speed Rewind/High-speed Playback): Plays video recording in high-speed in reverse or normally. Repeatedly tap on the button to play in a higher speed. The speed can be changed in 3 levels.
- (Go to Beginning/End): Go to the first/last video among the recording data of the selected date.

NOTE: *Go to Beginning/End* is not supported in portrait mode.

- : Search events. If the device is a network camera or network video transmitter, only the events that occurred while SD Memory Card Recording feature is enabled can be searched.
- : Search videos recorded on specific date and time.
- : Show list of camera channels. In landscape mode, press and hold on the screen to bring up the camera channel list. Press the desired channel to view video recordings from the selected camera.

Event Query

You can search events by pressing  in Search & Play modes. If the device is a network camera or network video transmitter, only the events that occurred while video is recorded on SD Memory Card can be searched.

NOTE: This feature is NOT supported for PC-based DVRs.

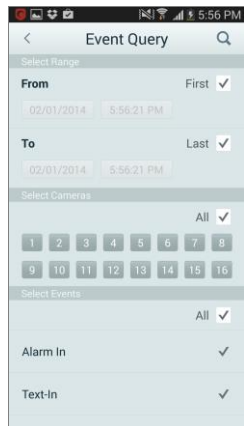

Event Query: Specify event-search parameters.

- **From / To:** Define the search range by specifying the starting and ending times and dates. To search the entire recording data, check the **First** and **Last** options.
- **Select Cameras:** Designate the target camera. To designate all cameras, select the **All** option.
- **Select Event:** Specify the type of the target event. To designate all events, select the **All** option.

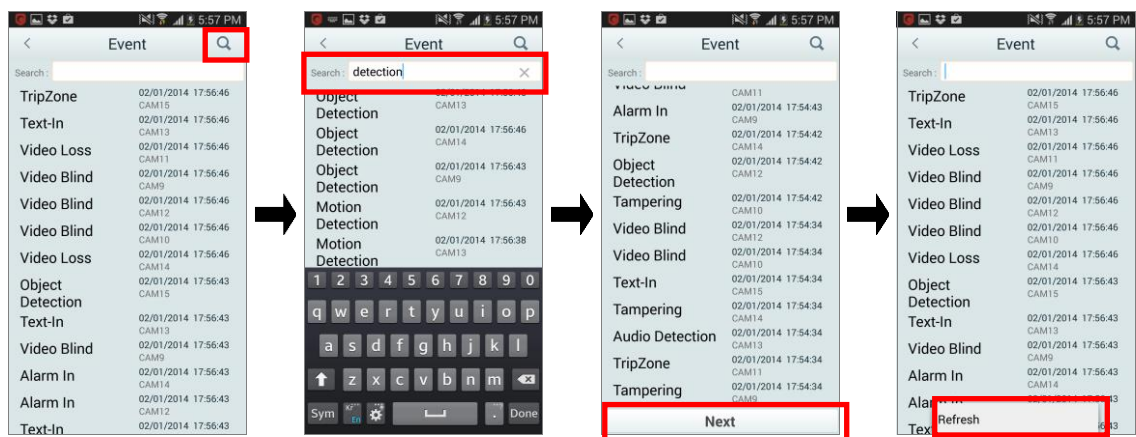

Event: Press  (Search) button on the title bar at the top to display searched events on the list.

- **Search:** Enter the search query. Event-recording entries that match the query are shown.
- **Event List:** Select an event from the list to play the corresponding recording. Tap **Next** at the bottom to see the next set of results (up to 100).
- **Refresh:** To search again using the same parameters, tap **Menu** on the mobile device and then select **Refresh**.

Calendar Search

You can search videos recorded from specific date and time by pressing  in Search & Play modes.

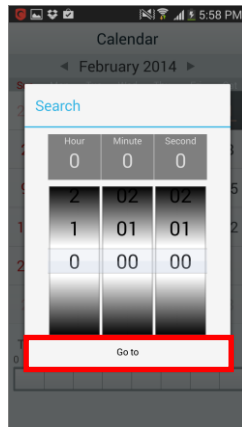

1. Dates that contain recording data are underlined. Select a date from the calendar to see a time graph of the available recording at the bottom.
2. Select a time range and then specify the Minute/Second.
3. Press Go to button. The video recordings for the selected time will be displayed on the screen.